

JCHR35W3C1/C2

Hand-held LCD Remote Controller

User Manual

01 Product Info

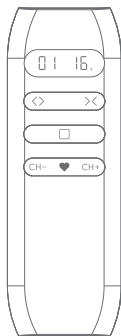

JCH35W3C1
16-channel LCD
remote controller

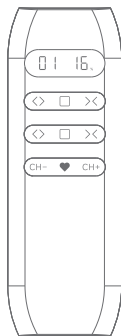

JCH35W3C2
16-channel dual control LCD
remote controller

02 Buttons

a. Front

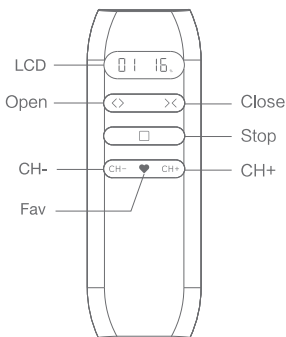

JCH35W3C1
16-channel LCD
remote controller

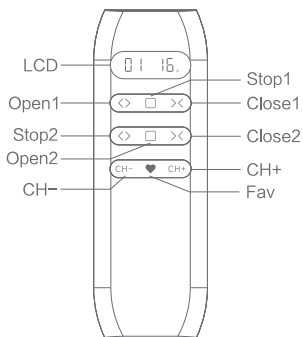

JCH35W3C2
16-channel dual control LCD
remote controller

b. Back

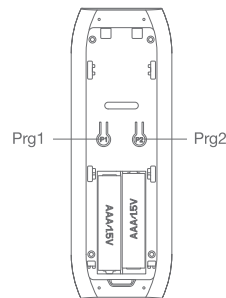

03 Parameters (more info please refer to the nameplate)

Electrical Specification	Standard
Battery Type	AAA battery*2
Working Temperature	-10°C-50°C
Radio Frequency	433.92M±100KHz
Transmit Distance	>=30m indoor

04 Caution!



1. The transmitter should not be exposed to moisture or impact, so as not to affect its life.
2. During use, when the remote control distance is significantly shorter or less sensitive, please check whether the battery needs to be replaced.
3. When the voltage is too low, the LCD screen digital display will be weak, prompting to replace the battery.
4. Please properly dispose of used batteries according to the local garbage classification and recycling policy.

05 Instructions

a. Channels & Groups Toggling

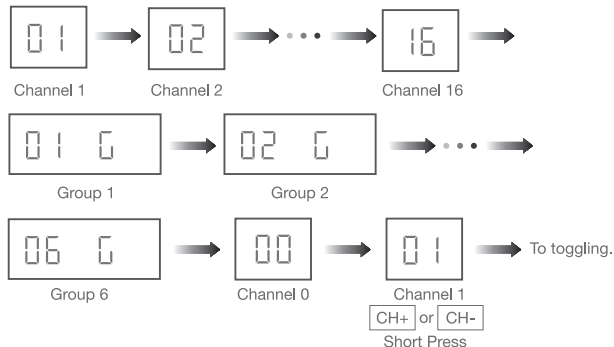

Note: Channel 0 is the group control for all the channels.

b.Number of Channels Setting



Note: Max&Min number is 16&1 when it's set under channel 1-16.

c.Number of Groups Setting

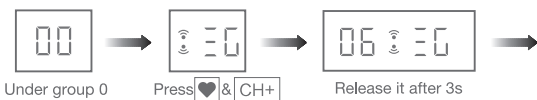

Note: Max&Min number is 6&0 when it's set under channel 0.

d.Channel in Group Setting

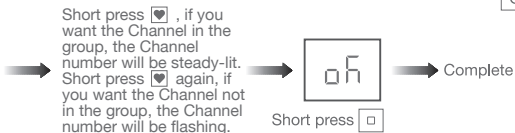
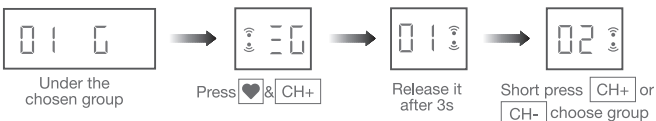

Note: Channel in groups setting is under GROUP 1-6.

e.Check the Channels in Groups



f.Prohibit Dual-key Operation

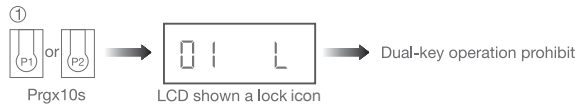

② Repeat the above, dual-key operation activated

Note: When dual-key operation prohibited, these programming setting functions are not allowed.

g.Position Percent Setting



Stop on the desired percentage down and wait 3s. The shades will move to the chosen percentage down position.

Note: All the shades under same group will run to same position after percent setting.

h.For other operations, please refer to the motor operation instruction