

# JCHR35W3A9/10

## Remote Controller

### User Manual

#### 01 Product Info

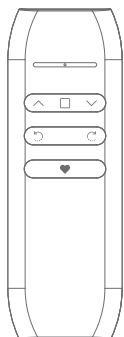

JCHR35W3A9

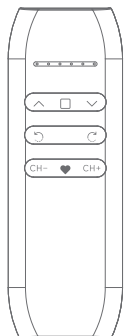

JCHR35W3A10

#### 02 Buttons

##### a.Front

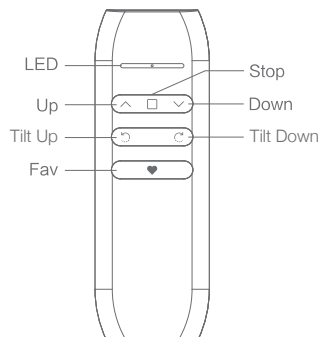

JCHR35W3A9

Single channel remote controller

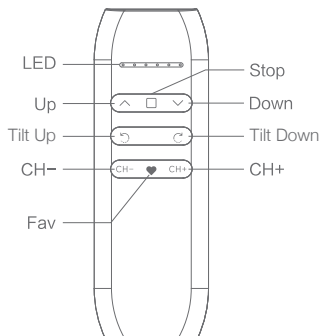

JCHR35W3A10

6-channel remote controller

##### b.Back

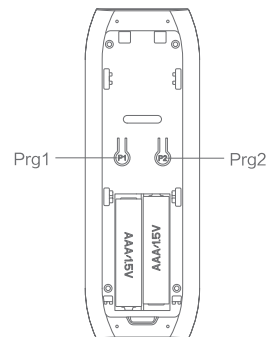

#### 03 Parameters (more info please refer to the nameplate)

Electrical Specification	Standard
Battery Type	AAA battery*2
Working Temperature	-10°C-50°C
Radio Frequency	433.92M±100KHz
Transmit Distance	>=30m indoor

#### 04 Caution!



- 1.The transmitter should not be exposed to moisture or impact, so as not to affect its life
- 2.During use, when the remote control distance is significantly shorter or less sensitive, please check whether the battery needs to be replaced.
- 3.When the battery voltage is too low, orange LED flickers when you press button, indicating to replace battery.
- 4.Pls properly dispose of used batteries according to the local garbage classification and recycling policy.

## 05 Instructions

### a. Prohibit Dual key Operation

①



② Repeat the above, dual-key operation activated

Note: When dual-key operation prohibited, these programming setting functions are not allowed, such as limits setting.

### b. Number of Channels Setting (Only apply to JCHR35W3A10)

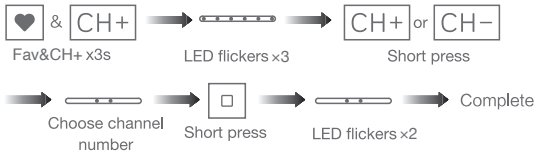

Note: When all LEDs are lit, that is channel 0 (All channels move together).

### c. For other operations, pls refer to the motor user manual